

CLASS 1500#

ANSI B16.5 • Standard Forged Flanges Dimensional Data

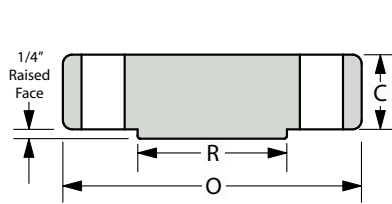

BLIND (BL)

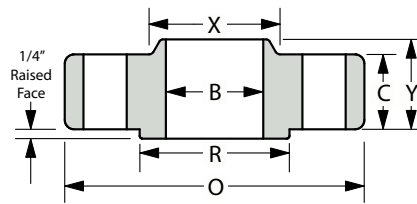

SLIP-ON (SO)

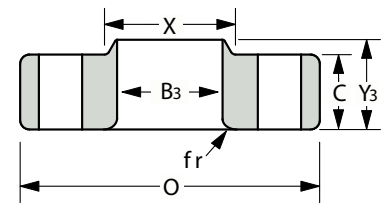

LAP JOINT (LJ)

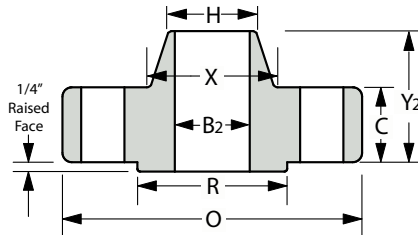

WELD NECK (WN)

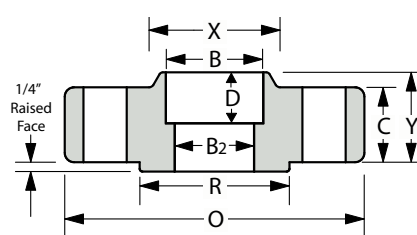

SOCKET WELD (SW)

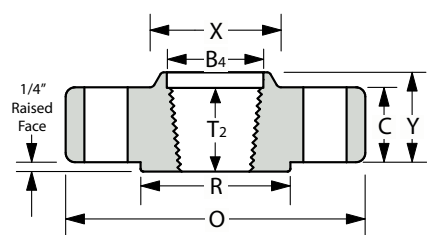

THREADED (TH)

Nom. Pipe Size	O (Outside Diameter)	R (Raised Face)	X (Hub Dia.)	C	T2 (Min. Thread Length)	Y (Overall Length)	Y2	Y3	B (Inside Dia.)	B2	B3	B4	fr	D	H (bevel hub)	# of Holes - Diameter	Bolt Circle Dia.
1/2"	4.75	1.38	1.50	0.88	0.88	1.25	2.38	1.25	0.88	This dimension is determined by the pipe schedule and its corresponding inside diameter.	0.90	0.93	0.13	0.38	0.84	4-0.88	3.25
3/4"	5.13	1.69	1.75	1.00	1.00	1.38	2.75	1.38	1.09		1.11	1.14	0.13	0.44	1.05	4-0.88	3.50
1"	5.88	2.00	2.06	1.13	1.13	1.63	2.88	1.63	1.36		1.38	1.41	0.13	0.50	1.32	4-1.00	4.00
1-1/4	6.25	2.50	2.50	1.13	1.19	1.63	2.88	1.63	1.70		1.72	1.75	0.19	0.56	1.66	4-1.00	4.38
1-1/2	7.00	2.88	2.75	1.25	1.25	1.75	3.25	1.75	1.95		1.97	1.99	0.25	0.63	1.90	4-1.13	4.88
2	8.50	3.62	4.13	1.50	1.50	2.25	4.00	2.25	2.44		2.46	2.50	0.31	0.69	2.38	8-1.00	6.50
2-1/2	9.63	4.12	4.88	1.63	1.88	2.50	4.13	2.50	2.94		2.97	3.00	0.31	0.75	2.88	8-1.13	7.50
3"	10.50	5.00	5.25	1.88	2.00	2.88	4.63	2.88	3.57		3.60	3.63	0.38	*	3.50	8-1.25	8.00
4"	12.25	6.19	6.38	2.13	2.25	3.56	4.88	3.56	4.57		4.60	4.63	0.44	*	4.50	8-1.38	9.50
5"	14.75	7.31	7.75	2.88	2.50	4.13	6.13	4.13	5.66		5.69	5.69	0.44	*	5.56	8-1.63	11.50
6"	15.50	8.50	9.00	3.25	2.75	4.69	6.75	4.69	6.72		6.75	6.75	0.50	*	6.63	12-1.50	12.50
8"	19.00	10.62	11.50	3.63	3.00	5.63	8.38	5.63	8.72		8.75	8.75	0.50	*	8.63	12-1.75	15.50
10"	23.00	12.75	14.50	4.25	3.31	6.25	10.00	7.00	10.88		10.92	10.92	0.50	*	10.75	12-2.00	19.00
12"	26.50	15.00	17.75	4.88	3.63	7.13	11.13	8.63	12.88		12.92	12.92	0.50	*	12.75	16-2.13	22.50
14"	29.50	16.25	19.50	5.25	*	*	11.75	9.50	*		14.18	14.18	0.50	*	14.00	16-2.38	25.00
16"	32.50	18.50	21.75	5.75	*	*	12.25	10.25	*		16.19	16.19	0.50	*	16.00	16-2.63	27.75
18"	36.00	21.00	23.50	6.38	*	*	12.88	10.88	*	18.20	18.19	0.50	*	18.00	16-2.88	30.50	
20"	38.75	23.00	25.25	7.00	*	*	14.00	11.50	*	20.25	20.19	0.50	*	20.00	16-3.13	32.75	
24"	46.00	27.25	30.00	8.00	*	*	16.00	13.00	*	24.25	24.19	0.50	*	24.00	16-3.63	39.00	

1. The C and Y dimensions do not include the 1/4" raised face for the 600# and above weight classes.

2. Tolerances are standard as per ANSI B 16.5

3. The Y3 dimension is the length for a "true" lap joint, however, it is usually accepted to make these to a standard slip-on length.

4. All shown dimensions are in inches. 5. Bolts 1/8" smaller than hole dia.

5. Columns marked * have no corresponding value in ASME code, therefore, have been left blank.